

Applies To: **2001-02 Civic EX** – See VEHICLES AFFECTED

**April 2002**

## Driver's Seat Rocks

(Supersedes 01-057, dated September 2001)

### SYMPTOM

The driver's seat rocks back and forth during normal driving.

### PROBABLE CAUSE

The front seat link bushings are worn.

### VEHICLES AFFECTED

2001 Civic EX: ALL

2002 Civic EX:

2-door

KE, KG: From VIN 1HGEM2...2L600001 thru VIN 1HGEM2...2L601995

KK: From VIN 1HGEM2...2L500001 thru VIN 1HGEM2...2L500041

KX: From VIN 1HGEM2...2L900001 thru VIN 1HGEM2...2L901201

KY: ALL

4-door

KK: From VIN 1HGES1...2H500001 thru VIN 1HGES1...2H500757

From VIN 2HGES1...2H750001 thru VIN 2HGES1...2H750119

KX: From VIN 1HGES1...2L900001 thru VIN 1HGES1...2L904288

### CORRECTIVE ACTION

Install new seat bushings.

### PARTS INFORMATION

Seat Link Bushing (six required):

P/N 90502-S3N-013, HC 6690440

### WARRANTY CLAIM INFORMATION

**In warranty:** The normal warranty applies.

Operation Number: 851133

Flat Rate Time: 0.5 hour

Failed Part: P/N 81536-S5P-A71  
HC 6526230

Defect Code: 005

Contention Code: B99

### REPAIR PROCEDURE

1. Remove the driver's seat from the vehicle. Refer to the body section in the 2001-02 Civic Shop Manual.
2. Remove the recline handle by pulling it forward.

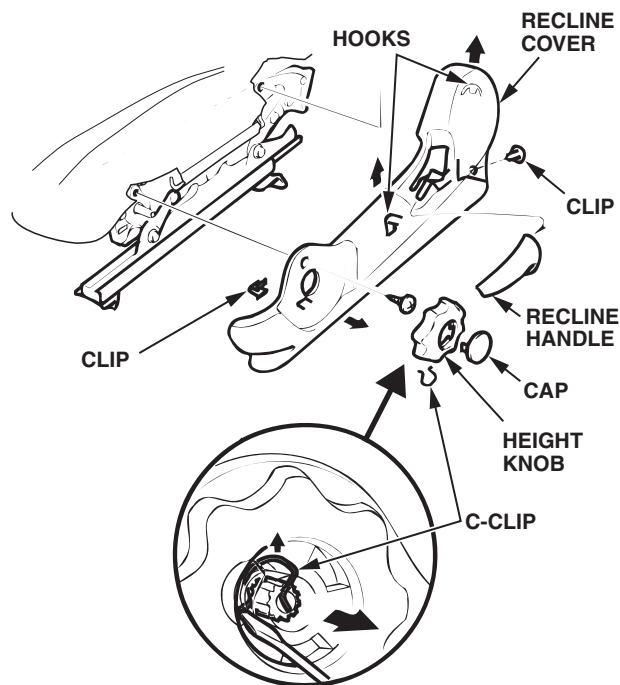

3. Remove the center cap from the height knob. Remove the C-clip that holds the height knob. Then remove the knob.
4. Remove the screw and clips from the recline cover. Remove the recline cover.

5. Remove the three nuts and washers from the outboard link and the outboard seat track.

**Outboard Side:**

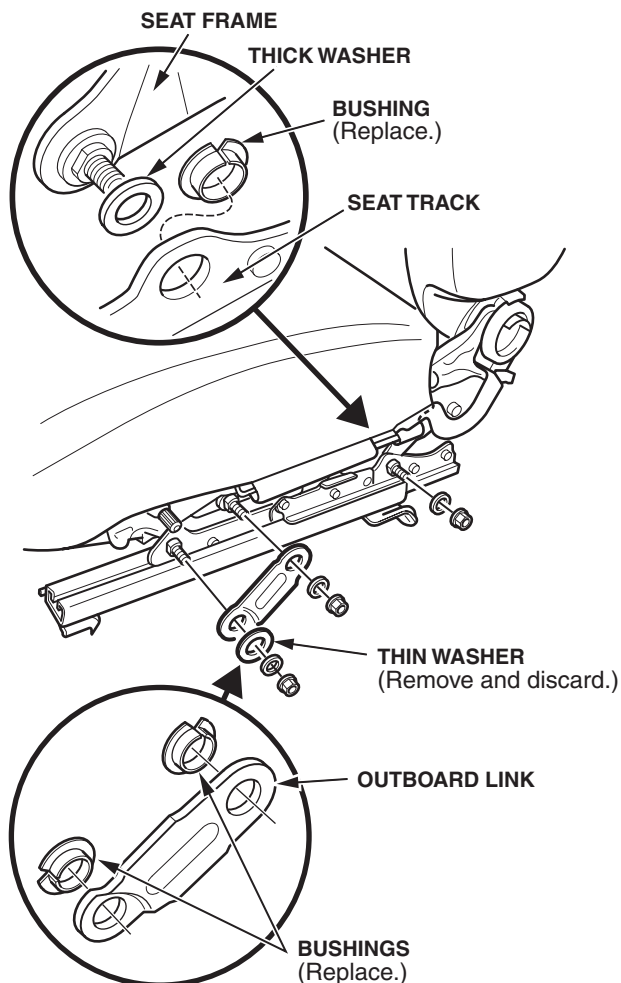

6. Remove and discard the thin washer from the front link. Remove and discard the old bushings.
7. Install the new bushings.
8. Reassemble the outboard side of the seat track in the reverse order of removal. Torque the nuts to 24 N·m (17 lb-ft).  
NOTE: Make sure you install the thick washer in the same position.
9. Install the recline cover.

10. Remove the seat belt buckle.

**Inboard Side:**

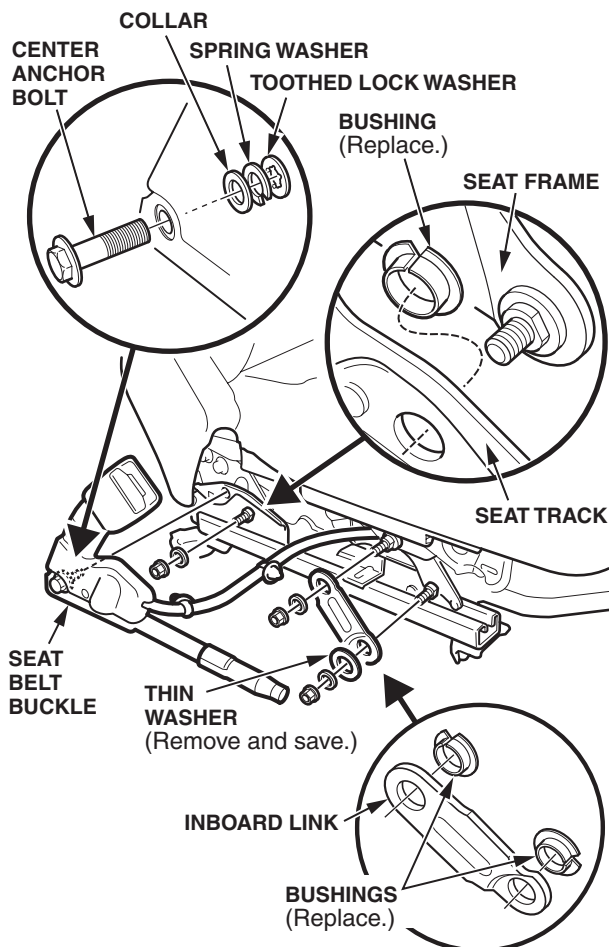

11. Remove the three nuts and washers from the inboard link and the inboard seat track. Remove and discard the old bushings.
12. Install the new bushings.

13. Install the thin washer that you removed from the front link on the rear mounting stud for the seat track.

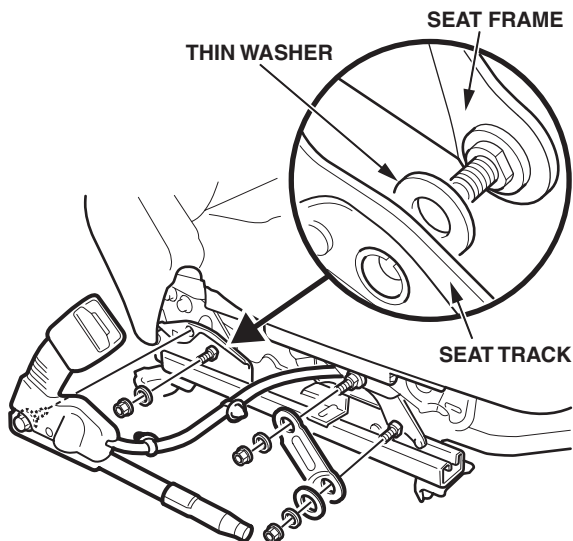

14. Reassemble the inboard side of the seat track in the reverse order of removal. Torque the seat track mounting nuts to 24 N·m (17 lb-ft). Torque the seat belt buckle mounting bolt to 32 N·m (23 lb-ft).
15. Install the seat.
16. Confirm that the problem is resolved. If the driver's seat still rocks, look for other causes.