

Heating

Power Transistor Test

1. Remove the passenger's dashboard lower cover (see page 20-101).
2. Disconnect the 4P connector from the power transistor.
3. Measure the resistance between the No. 3 and No. 4 terminals of the power transistor. It should be about 1.4–1.5 k Ω .
 - If the resistance is within the specifications, go to step 4.
 - If the resistance is not within the specifications, replace the power transistor.

POWER TRANSISTOR

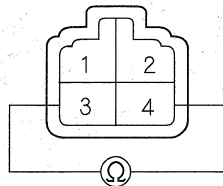

4. Carefully release the lock tab on the No. 1 terminal (BLU/YEL) (A) in the 4P connector, then remove the terminal and insulate it from body ground.

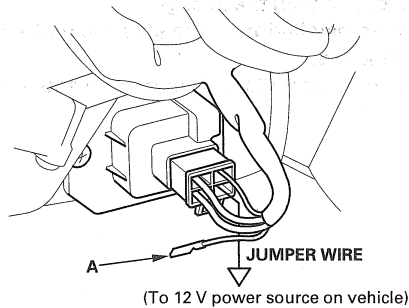

5. Reconnect the 4P connector to the power transistor.
6. Supply 12 volts to the No. 1 cavity with a jumper wire.
7. Turn the ignition switch ON (II), and check that the blower motor runs.
 - If the blower motor does not run, replace the power transistor.
 - If the blower motor runs, the power transistor is OK.

Heater Control Panel and Push Switch Assembly Removal and Installation

1. Remove the center panel (see page 20-101).
2. Remove the dials (A), then remove the self-tapping screws and the heater control panel (B) from the center panel (C). Remove the self-tapping screws and the push switch assembly (D) from the center panel.

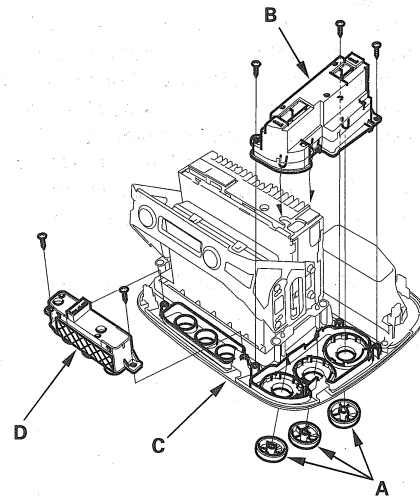

3. Install the control panel and the push switch assembly in the reverse order of removal. After installation, operate the control panel controls to see if they work properly.
4. Run the self-diagnosis function to confirm that there are no problems in the system (see page 21-4).