

Mirrors

Mirror Holder Replacement

1. Adjust the mirror fully to the inward position.
2. Insert a long, thin, flat-tipped screwdriver along the ribs (A) on the mirror holder (B). Slide the tip of the screwdriver between the mirror holder and the actuator (C).

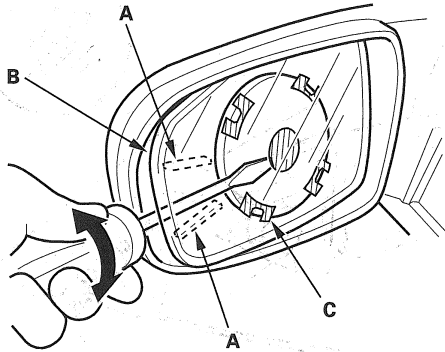

3. Quickly twist the screwdriver to separate the mirror holder from the mirror actuator.
4. Insert the screwdriver further under the mirror holder and twist it again.

NOTE: Do not pry up on the mirror holder to separate the two parts, as this can cause either the mirror glass or actuator to break.

5. Separate the mirror holder (A) from the actuator (B) by hand, slowly pulling them apart while separating the adhesive (C), and detaching the clips (D). Disconnect the mirror defogger connectors (E) from the heater pad terminals.

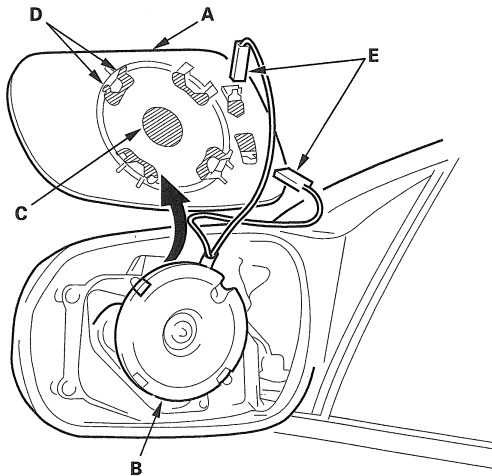

6. Remove any remaining adhesive from the actuator.
7. Reconnect the mirror defogger connectors.
8. Remove the clips from the mirror holder, and install them on the actuator. Position the mirror holder on the actuator, and carefully press on the clip portions until the mirror holder snaps into place.
9. Check the operation of the actuator.