

- Remove the driver's dashboard under cover. Turn the knob counterclockwise, and release the two clips and one retaining tab.

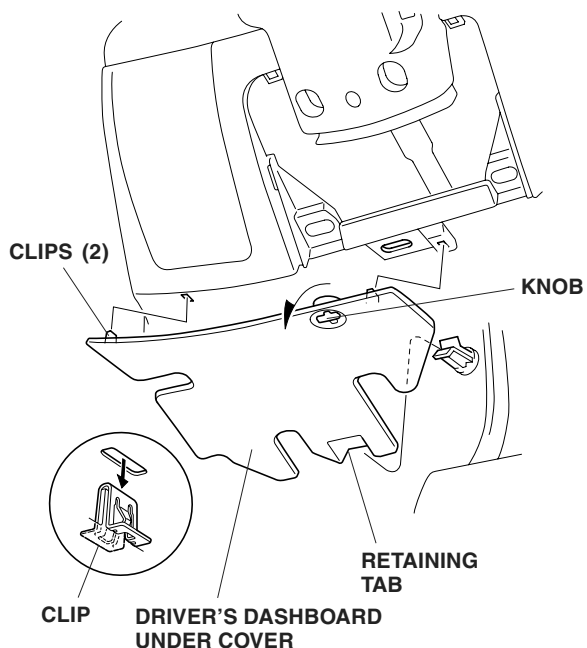

- Pry up on the four retaining tabs and remove the escutcheon.

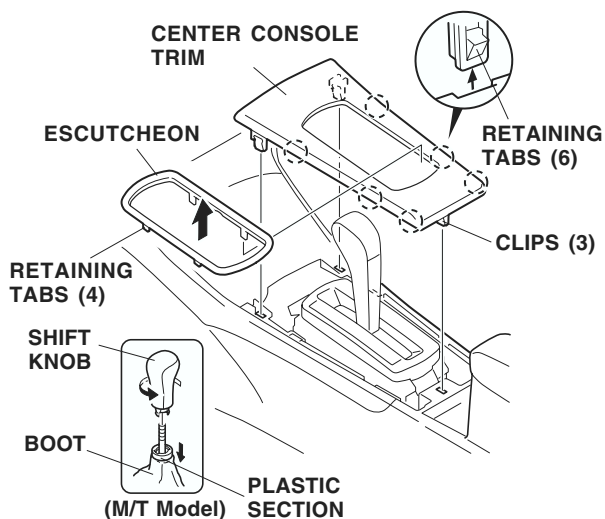

- Pry up on the three clips and six retaining tabs and remove the center console trim. On the M/T model, remove the shift knob from the lever by pulling the plastic section above the boot down firmly with one hand, while you turn the knob counterclockwise with the other hand.

- Remove the center lower trim:
  - With the parking brake applied, place the gear shift lever in the Neutral position.
  - Remove the two self-tapping screws that fasten the lower trim.
  - Gently pry out on the lower trim to release the nine clips and the one retaining tab.
  - Unplug the accessory socket connector, and remove the lower trim.

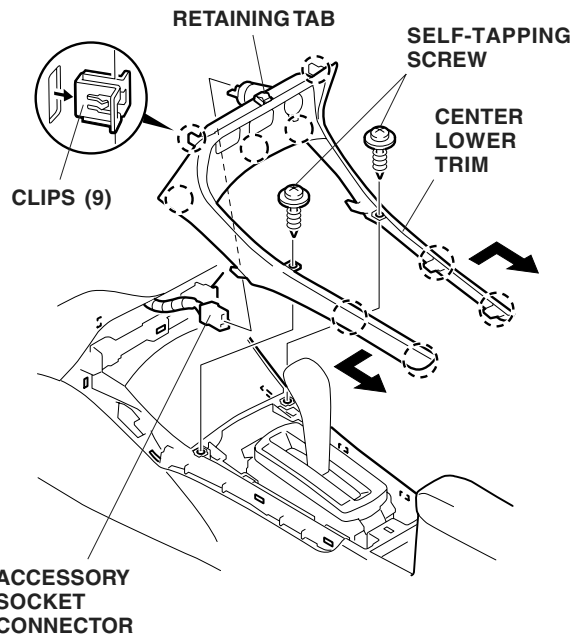

- Remove the four self-tapping screws that fasten the center lower switch panel to the center lower trim, and remove the switch panel from the trim.

