

Openers

Trunk Lid Opener/Fuel Fill Door Opener Replacement

Special Tools Required
KTC trim tool set SOJATP2014

NOTE: Use the appropriate tool from the KTC trim tool set to avoid damage when prying components.

1. Using a trim tool, detach the hooks (A) by prying the front side cap (B), then remove it from the front door sill trim (C), and remove the opener lock cylinder (D).

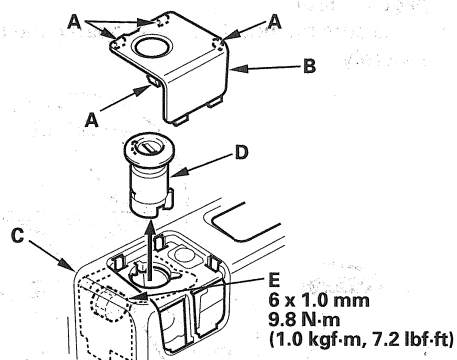

2. Loosen the bolt (E) securing the fuel fill door opener.
3. Remove the door sill trim, 2-door (see page 20-83), and/or the front door sill trim, 4-door (see page 20-84).
4. Remove the opener (A) from the bolt (B).

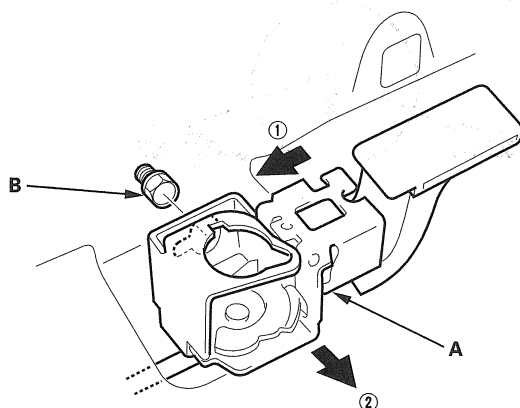

5. Disconnect the trunk lid opener/fuel fill door opener cable (A), then remove the opener (B). Take care not to kink the cable.

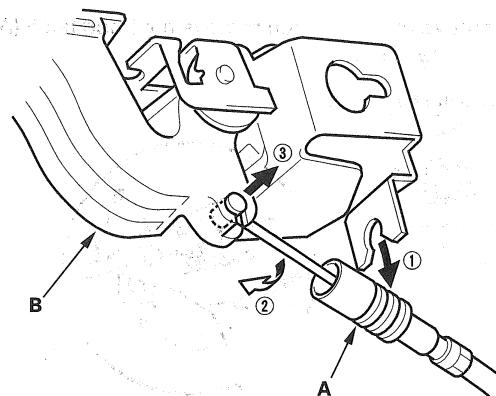

6. Install the opener in the reverse order of removal, and note these items:
 - Make sure the opener cable is connected properly.
 - Make sure the trunk lid and fuel fill door open properly and lock securely.